

MICRO SWITCH

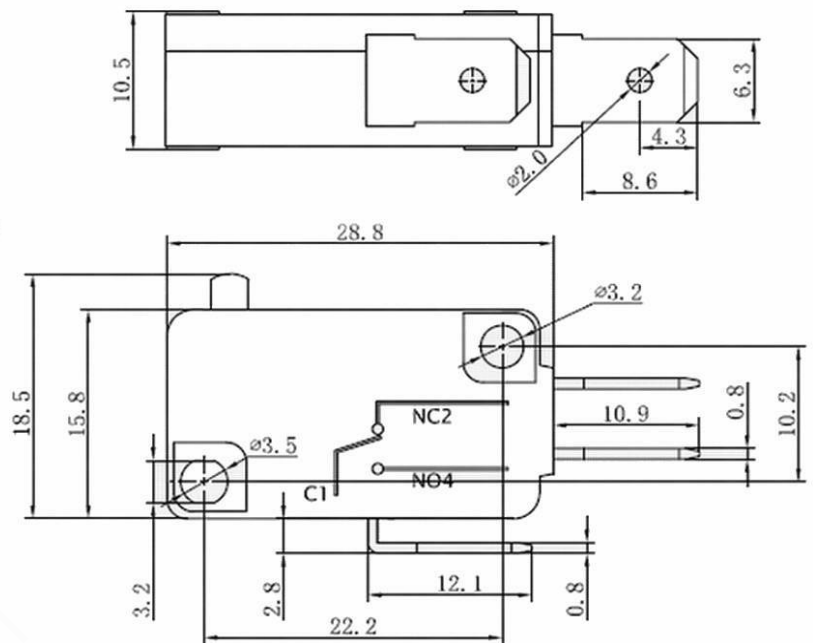

Widely used in Juicer, Coffee Maker, Stirrer, etc appliances

Technical parameters

Electrical parameters	15.1A125/250Vac 16(6)A250Vac T125
Electrical life	50000cycles
Mechanical life	100000 cycles
Contact resistance	$\leq 50\text{m}\Omega$
Insulation Resistance	$\geq 100\text{m}\Omega$
Voltage withstand	1500Vac
Ambient temperature	0-125°C
Flammability	V-0
Fire resistance	850°C
Housing and Cap material	PA66
Contact material	Sliver Alloy
Terminal material	Brass Alloy
Approval Certification	UL, VDE, CQC

How to order

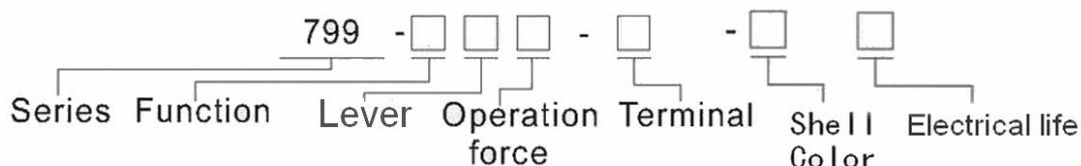

Function option		
Function	Circuitry	Code
SPDT CHANGE	3 Pins	1
SPST NORMAL OPEN	2 Pins	2
SPST NORMAL CLOSE	2 Pins	3

Operation Force option	
Operation Force	Code
$70 \pm 30\text{gf}$	1
$120 \pm 30\text{gf}$	2
$180 \pm 30\text{gf}$	3
$260 \pm 60\text{gf}$	4

Terminal option		
Terminals	Versions	Code
Quick-connect terminal 4.8X0.5mm		1
Quick-connect terminal 4.8X0.8mm		2
Quick-connect terminal 6.3X0.8mm		3
Solder Terminal		4

Shell color option	
	Code
Black	1
Gray	2

Electrical life option	
Electrical life	Code
10000 cycles	1
50000 cycles	2

Lever option	
Versions	Code
Normal head button	A
Inclined head button	B
Round head button	C
14	D
27	E
40	F
25.6	G
30	H
40	I
	J
	K
	L